



Ark Serene  
County  
@ White Fields

The Finest Lifestyle  
in  
Happening Destination



## Good Living is all about Capital Appreciation

A good investment prospect is rare to find. A location brimming with opportunities holds a great promise for the future. Make a shrewd decision and grab the deal instinctively. The property will yield rich dividends in no time.

**Do you have it in your home?**



## Specifications

<b>Structure:</b> RCC-framed structure
<b>Super Structure:</b> 6" thick cement concrete block masonry for external walls and 4" thick cement concrete block masonry for internal walls
<b>Plastering:</b> All internal and external walls with smooth plaster finish
<b>Doors:</b> Main door in Teak frame with moulded masonite skin flush door shutters and internal doors in non-teak wood frame with flush door shutters
<b>Windows:</b> Powder coated aluminium windows with MS safety grills
<b>Painting:</b> All internal walls with putty finish and two coats of ORB over a coat of primer, External walls with two coats of exterior emulsion paint of Asian or equivalent make over a coat of primer
<b>Flooring:</b> Hall, dining and bedrooms with vitrified tiles (24"x24") Somany or equivalent make, Ceramic tile flooring in all other areas with Asian tiles or equivalent make, Marble/Granite flooring in corridors and staircases, Anti-skid ceramic tiles (12"x12") Asian tiles or equivalent make in toilets
<b>Dadoing:</b> Kitchen: Glazed ceramic tiles dado upto 2'0" height above kitchen platform. Toilets: 8"x12" glazed ceramic tile dado of Asian tile of equivalent make upto 7'0" height
<b>Kitchen:</b> Granite platform with stainless steel sink
<b>Plumbing &amp; Sanitaryware:</b> CP fittings of MAIRC / loquor or equivalent make in toilets and kitchen, Cera / Hindware / Parryware or equivalent make sanitaryware in all toilets
<b>Electrical:</b> Concealed copper wire of Anchor or equivalent make, Modular switches: Legrand or equivalent make, TV, telephone points in living and master bedroom, AC power point in master bedroom and geyser point in all bathrooms
<b>Lifts:</b> 6 passenger capacity lifts of KONE or equivalent make
<b>Sewerage Treatment Plant:</b> A sewerage treatment plant of 150 KLD capacity will be provided to treat the waste water
<b>Note:</b> This brochure is only conceptual presentation and not a legal offering. The promoters reserve the right to alter and make changes in elevation, highlights, plans and specifications as deemed fit.

## 22 years of glorious construction experience!

**Ark Serene County**  
@ White Fields



Schneider Electric



Lumbini SLM Springs, Hyderabad



Ark Tulip, Hyderabad



Vasavi College, Hyderabad



AMD, Hyderabad



IT Officers Quarters, Hyderabad



SVEC, Suryapet

**Lifestyle environments with premium quality & affordability**

Ark Infra Developers Pvt Ltd is promoted by Ark Builders who have over 22 years of rich experience in construction field. The builders bring out quality lifestyles to aspiring clientele. Ark Infra homes are distinct with innovative designs and quality construction. The company enjoys the advantage of its promoters' vast experience in building residential ventures and infrastructure projects for corporates and Government institutions.

At the helm of affairs is Sri G Ram Reddy, a technocrat and a visionary turned into an entrepreneur under whose leadership a competent team of engineers and experienced work force work to realize customer dreams into a reality.

**Discover exciting future on firm foundations.**

## Hyderabad's first CRISIL 5-star rated project

560 Apartments in 7.5 acres



Ark Homes, Hyderabad

## Why Ark Serene County is your first choice?

The experienced builders give the best value to the customers - a feel good environment coupled with hassle free transaction. The Serene County is your first choice because of:

- ✓ IDEAL LOCATION
- ✓ CLEAR TITLES
- ✓ AFFORDABLE PRICES WITH SUPERIOR QUALITY
- ✓ BRANDED FITTINGS & BEST SPECIFICATIONS
- ✓ ON-TIME DELIVERY
- ✓ HASSLE-FREE TRANSACTION
- ✓ AFTER-SALES SERVICE

## Good Living is all about Quality

Quality at every step brings cheer. Finer finishes, brand fittings and flooring are a joy forever. Good quality guarantees peace of mind.

Do you have it in your home?



# Ark Serene County

@ White Fields

Area Statement in sq ft

1	1720
2	1695
3	1165
4	1250
5	1250
6	1250
7	1250
8	1165
9	1695
10	1720
11	1385
12	1385
13	1385
14	1385
15	1385
16	1385
17	1385
18	1385
19	1385



Block-1 Typical Floor Plan



Area Statement in sq ft

Wing-A		Wing-B		Wing-C	
1	1825	1	1680	1	1825
2	1830	2	1680	2	1830
3	1165	3	1165	3	1555
4	1165	4	1165	4	1180
5	1165	5	1165	5	1180
6	1165	6	1165	6	1555
7	1745	7	1745	7	1700
8	1630	8	1230	8	1745
9	1180	9	1745	9	1165
10	1360	10	1165	10	1165
11	1360	11	1165	11	1165
12	1180	12	1165	12	1165
		13	1165		

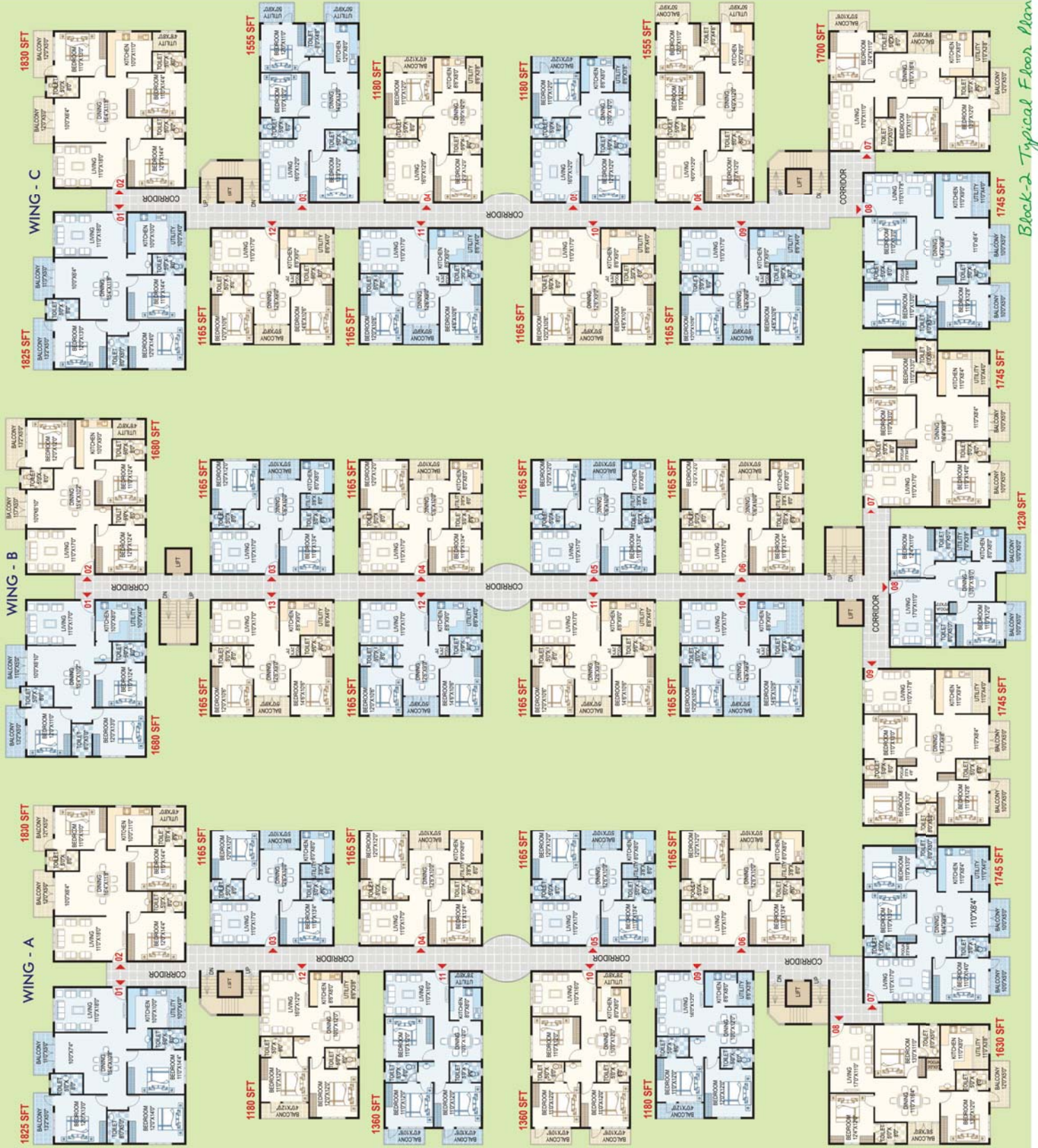



## Good Living is all about Recreation

Recreation begins at home. Hectic lifestyles demand better choice of recreation at one place. A wholesome entertainment package is what makes you return home in anticipation.

Do you have it in your home?

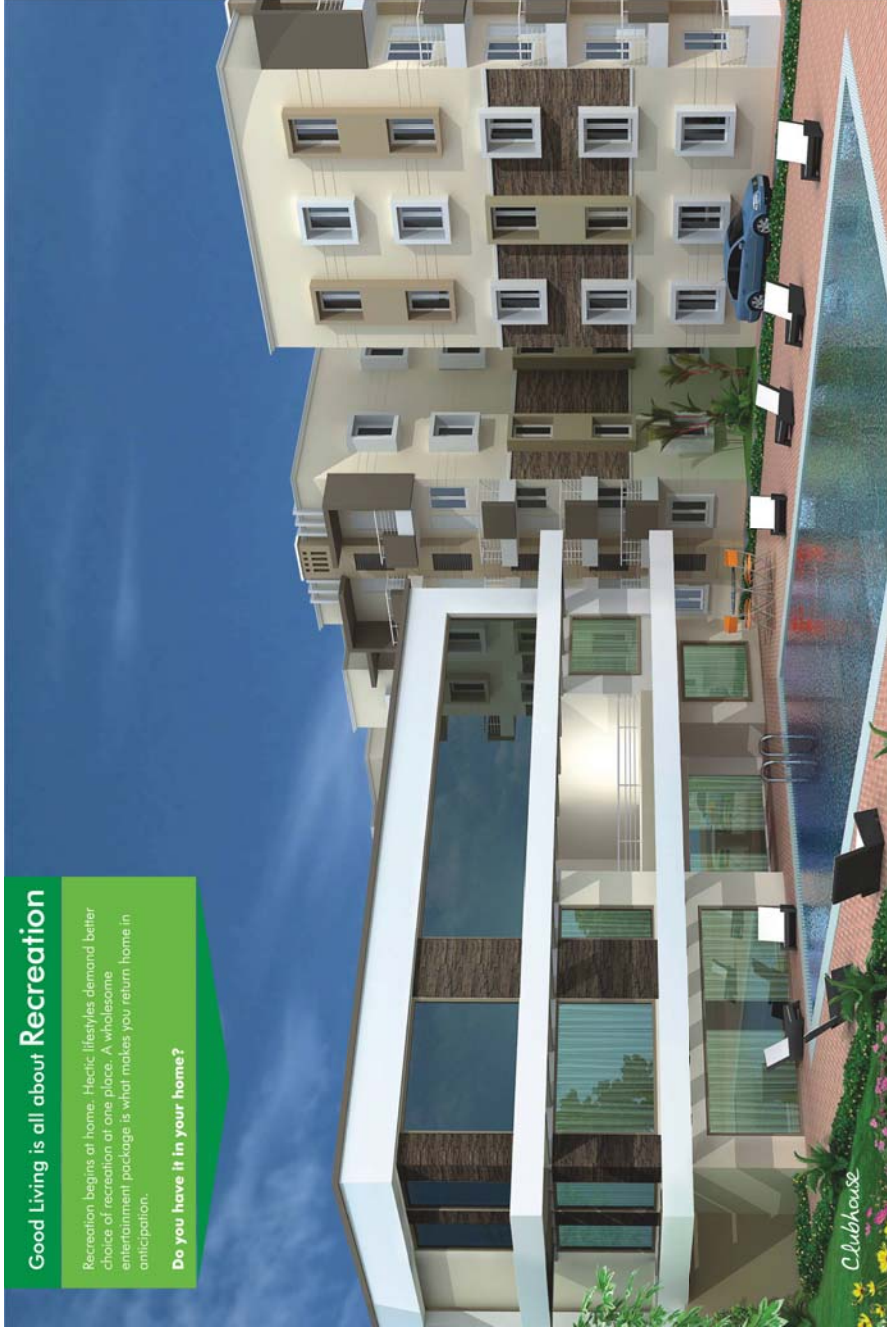

# Ark Serene County

@ White Fields

An exclusive clubhouse offers you a variety of recreation options that appeal to everyone in the family. Swimming pool invites you for a splash, the modern gymnasium keeps you fit. The indoor games enclave let you strengthen social relationships over a game or two. The multi-purpose hall will reverberate with parties and celebrations. Jogging track, play areas and green lawns offer you plenty of lung space.

You will never run out of fun times

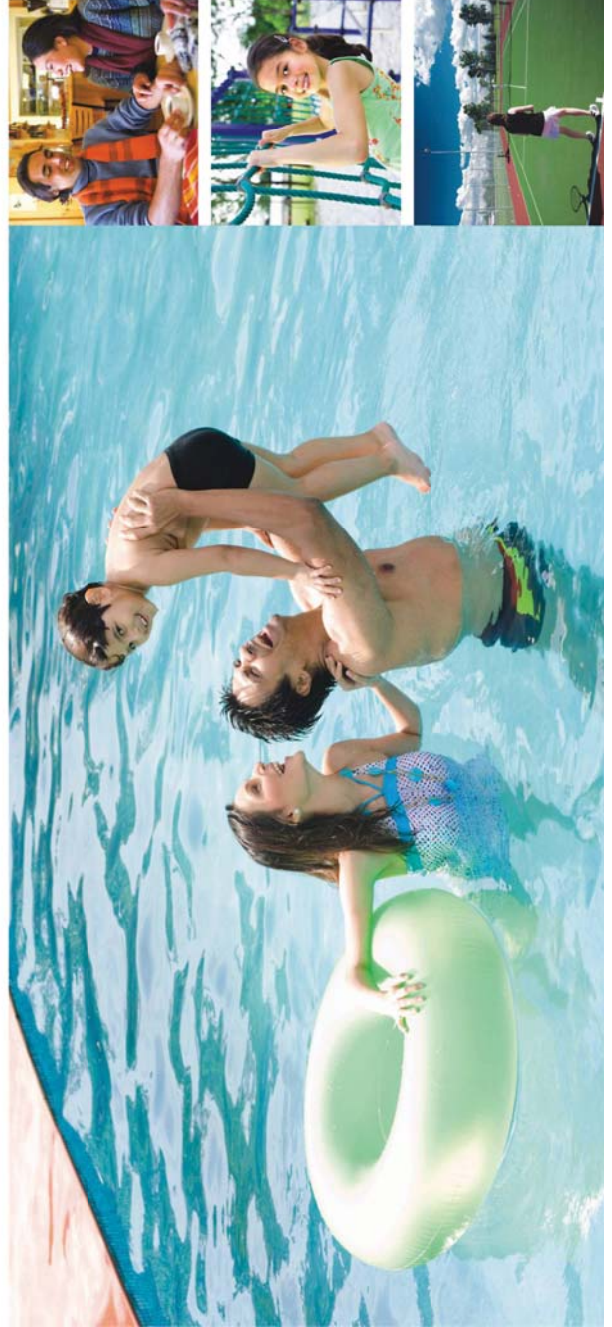

## Clubhouse Facilities

- MULTI-PURPOSE HALL
- SWIMMING POOL
- INDOOR GAMES
- A/C GYMNASIUM
- YOGA & MEDITATION HALL
- LAWN TENNIS
- CRÈCHE



## Good Living is all about Thoughtful Design

A thoughtful design defines spaces for greater happiness. It focuses on your needs and builds around your aspirations. Optimal space utilization, functional areas and a keen eye for aesthetics brings joy to the residents.

Do you have it in your home?



### Project Highlights

- BBMP-APPROVED PROJECT
- PREMIUM QUALITY CONSTRUCTION
- EARTHQUAKE RESISTANT DESIGN
- 2 & 3 BEDROOM APARTMENTS
- AS PER VAASTU
- NO COMMON WALLS
- IDEAL LOCATION
- EXCELLENT LANDSCAPING
- CHILDREN PLAY AREA
- SEWERAGE TREATMENT PLANT
- 24 HR SECURITY WITH INTERCOM
- RAIN WATER HARVESTING PITS
- STANDBY GENERATOR

# Ark Serene County

@ White Fields

Ark Serene County is designed to be affordable while being elaborate with facilities. The world class destination offers stunningly designed apartments with the finest features and sophisticated spaces that celebrate your daily living.

As functional spaces delight you, outdoors are connected through large windows and sit-outs. Enjoy the ambience as natural light streams in and breeze caresses your face gently.

Quality living,  
yet pleasantly  
affordable



## Good Living is all about Location

Location is the soul of your home. A central location with all amenities nearby is desirable. Make sure your office, shopping malls, restaurants, schools are all around in a few minutes' drive.

### Do you have fit in your home?



# Ark Serene County

@ White Fields

**Ark Serene County** is the gateway to the good life in a global destination. The promoters make sure that nothing is left to be desired for with an apartment in Ark Serene County. Be it connectivity with IT companies, shopping, schools or restaurants, Serene County is a matchless proposition. Cocooned in flawless green spaces, plenty of recreation facilities, the luxury project offers 2, 3 bedroom apartments to celebrate a lifestyle filled with vigor and vitality. The ambience is perfect for children to grow up and senior citizens to age gracefully.

For connoisseurs of life, this is the place to be

Three minute straight drive to your work place at ITPB

## Location Map

(not to scale)



### Proximity to:

- WHITEFIELDS GLOBAL SCHOOL - 0.7 KMS
- PERIPHERAL RING ROAD - 1 KM
- HOPE FARM CIRCLE - 1.5 KMS
- ITPB - 2.5 KMS
- WHITE FIELDS RAILWAY STATION - 3 KMS
- FORUM VALUE MALL - 4.2 KMS
- SAIBABA HOSPITAL - 4.5 KMS
- VAIDEHI MEDICAL COLLEGE & HOSPITAL - 5.0 KMS
- HOODI CIRCLE - 5.7 KMS
- RYAN INTERNATIONAL SCHOOL - 6 KMS
- KUNDLAHALLI GATE - 8 KMS
- MARATHAHALLI BRIDGE - 9.4 KMS



Ryan International School



Forum Value Mall



Prestige Shantiniketan



Sai Hospital



ITPB



# Ark Serene County

@ White Fields

## Promoters



INFRA DEVELOPERS PVT. LTD  
trust..quality..commitment

**Corporate Office:** 6-3-666/A, Second Floor, Lumbini Towers  
Opp. NIMS, Punjagutta, Hyderabad - 500 082  
Ph: +91-40-64 583 583, 90001 32223, Fax: +91-40-2331 0465  
E-mail: sales@arkinfra.com  
[www.arkinfra.com](http://www.arkinfra.com)

**Site Address:** Ark Serene County, Chennasandra  
Beside MVJ College of Engineering, White Fields, Bengaluru - 560 067  
Ph: +91 9538 87 87 87/ 88, 080-2845 7838  
Fax: 080-2845 7839

## Architects

**Citadel** Architects & Engineers  
#799/1, 2nd Floor, 3rd Cross, Opp. Ganesh Temple  
New Thippasandra, Bengaluru - 560 075

## Structural Engineers

**Pralabhi Associates**  
24, CMH Road, Ulsoor Road, Bengaluru - 560 075  
Ph: +91 98454 95353

## MEP Consultants

**Sri Infra Consultants Pvt Ltd**  
# 738, 6-3-596/77/5A, Naveen Nagar, Hyderabad - 500 004  
Telefax: +91-40-2339 3961

## Landscape Consultants

**Conifer** Landscape Architects  
#190, Phase-II, Kamalapur Colony, Hyderabad - 500 073  
Ph: +91-40-2354 5488